

ZIPPITY

Easy Does It!

NEWBERRY

GATE HARDWARE KIT

ASSEMBLY INSTRUCTIONS

ZP19082

30 MIN

Approximate assembly time

Want to see a video on how to
assemble this product?
Scan the QR code



GENERAL INFORMATION

MISSING OR DAMAGED PARTS?



➤ **Visit Our Website**
so we can help you right away!
parts.nychbrands.com

* You can also reach us via phone or email.

Hours of Operation - **Weekdays 9am-5pm EST**

To better help you, **please have the following**

- Your product number (**ZP19082**)
- Your affected part letters (**Pages 3-4**)
- Your original product box

NEED ASSEMBLY HELP?

If you are having problems with assembly or installation of this product,
please contact at:

📞 **704-892-5222 / 877-234-6196** ✉ **support@zippity-outdoor.com**

NEED TO RETURN?

If for some reason you need to return this product, please allow us to help resolve your issues first. If you still decide to return the product, **you will need to initiate the return from the company you originally purchased from.**

LAY OUT MATERIALS

► Tools required for a smoother installation experience.

► We recommend 2 people for a smoother assembly.

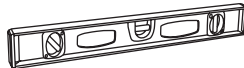

► Drill with Phillips bit

► Level

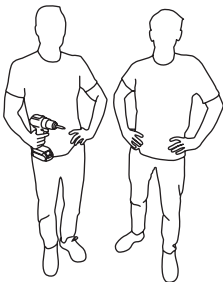

LATCH

A

Latch Catch

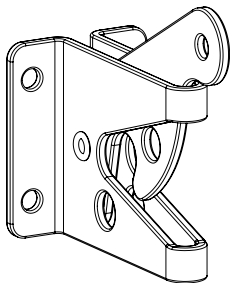

B

Latch Finger

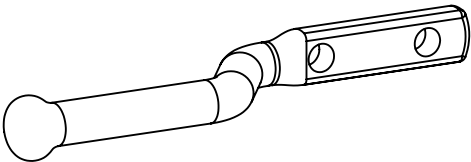

C

Latch Spacer (2)

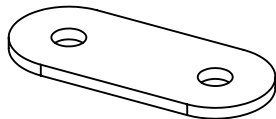

D

Back Plate (2)

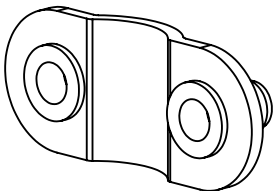

E

Adhesive Rubber Pad

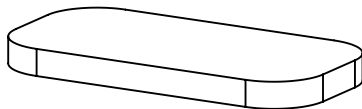

F

Gate Stopper

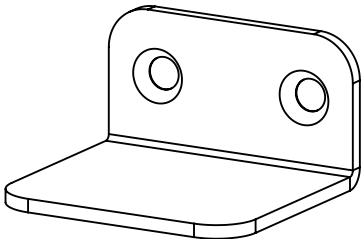

LAY OUT MATERIALS

HARDWARE

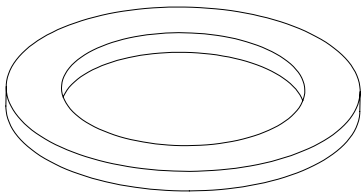

G

Low Friction Washer (2)

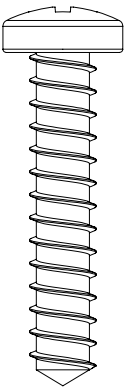

H

Screw (4)

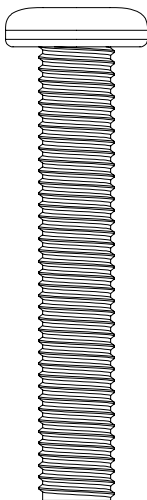

I

1 1/4in Bolt (4)

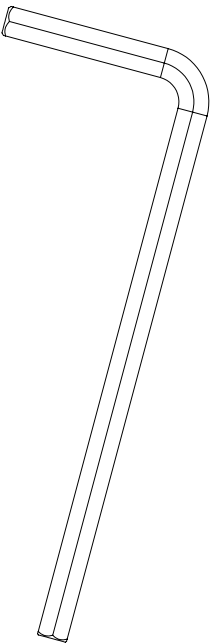

J

Hex Key

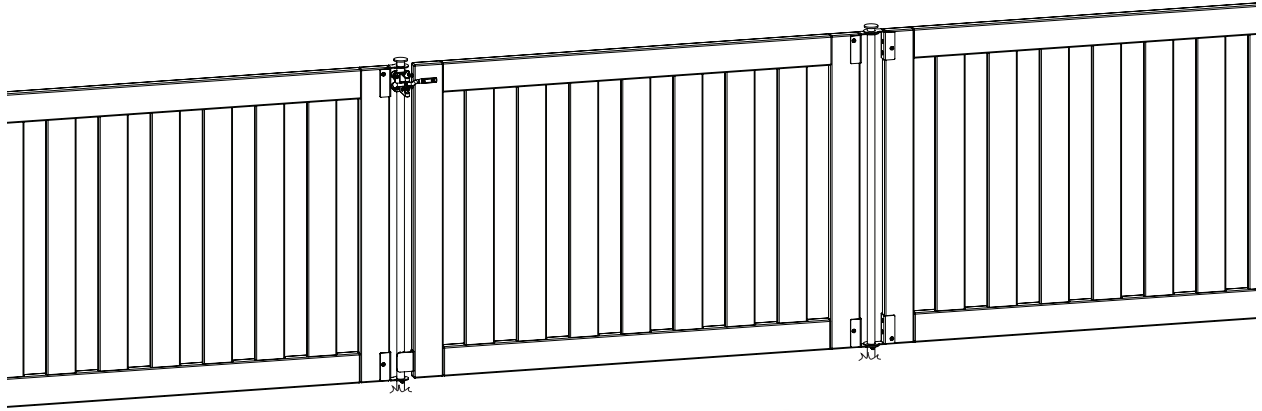

Always install your gate between two fence panels for stability.

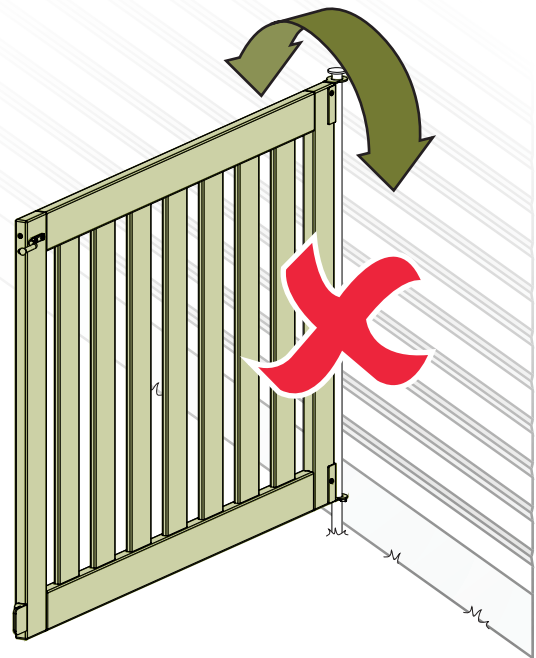
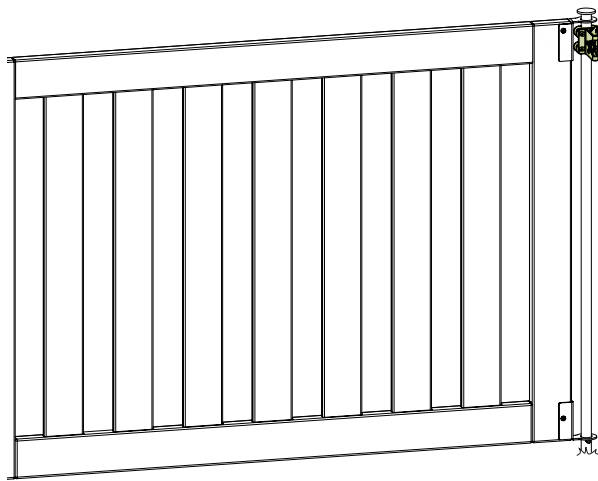

Never install your gate off of your last fence panel, to refrain from putting too much strain on the ground stake.

A Determine which fence panel you want to make into a gate.

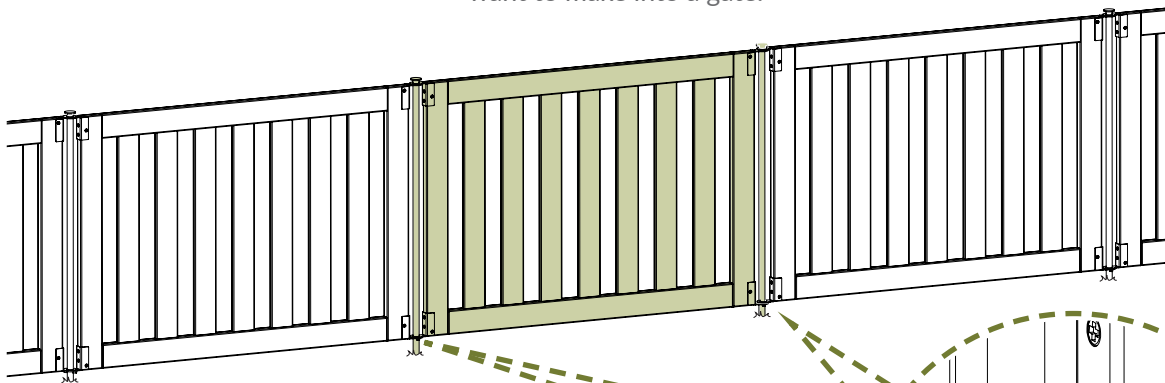

B Remove stake pegs from the left and right stakes.

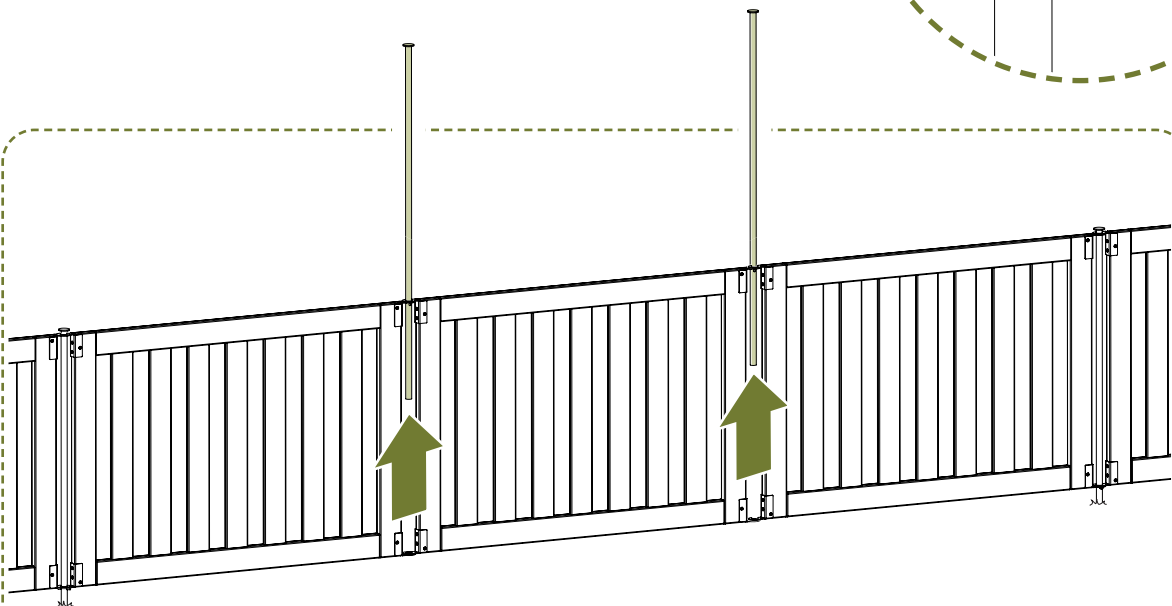
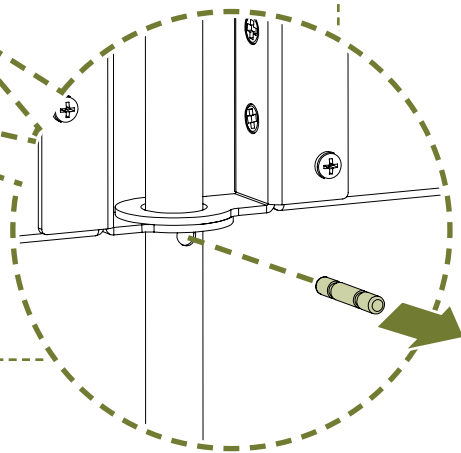

C Remove both Stakes.

ASSEMBLE UNIT

1



From one side of your loose panel, begin removing the top and bottom brackets.

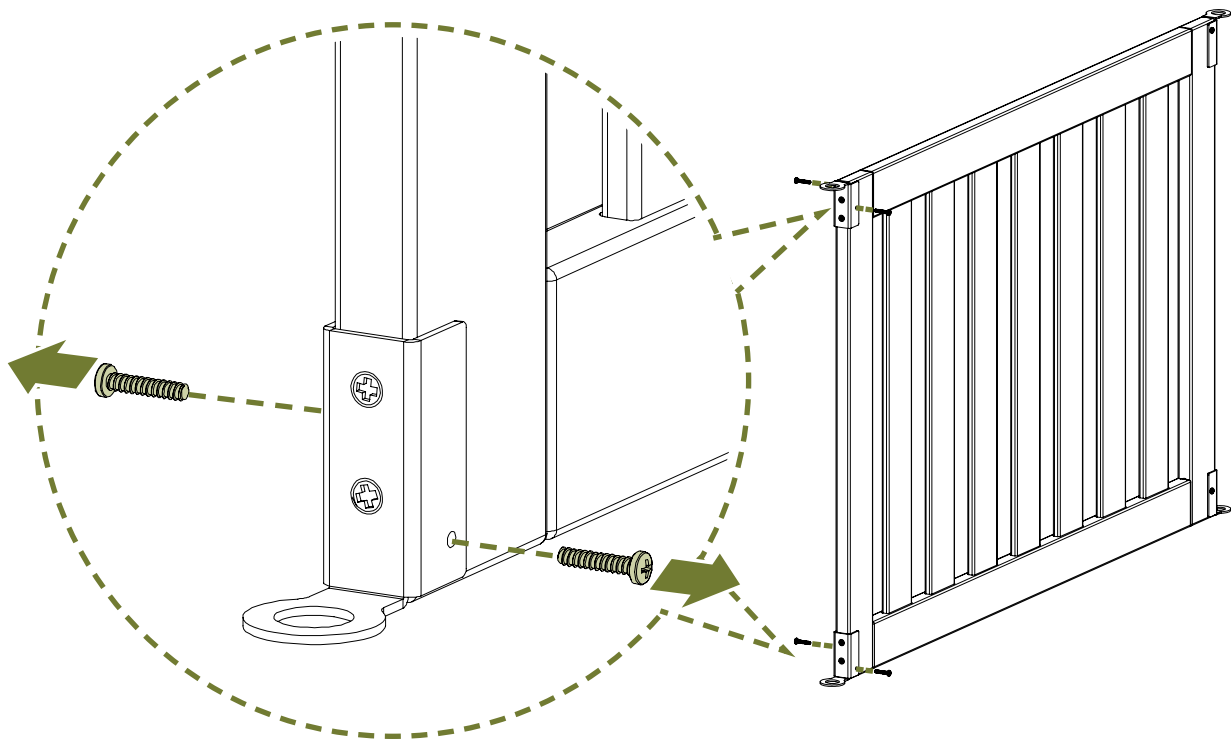

ASSEMBLE UNIT

2



Fully remove top and bottom brackets.

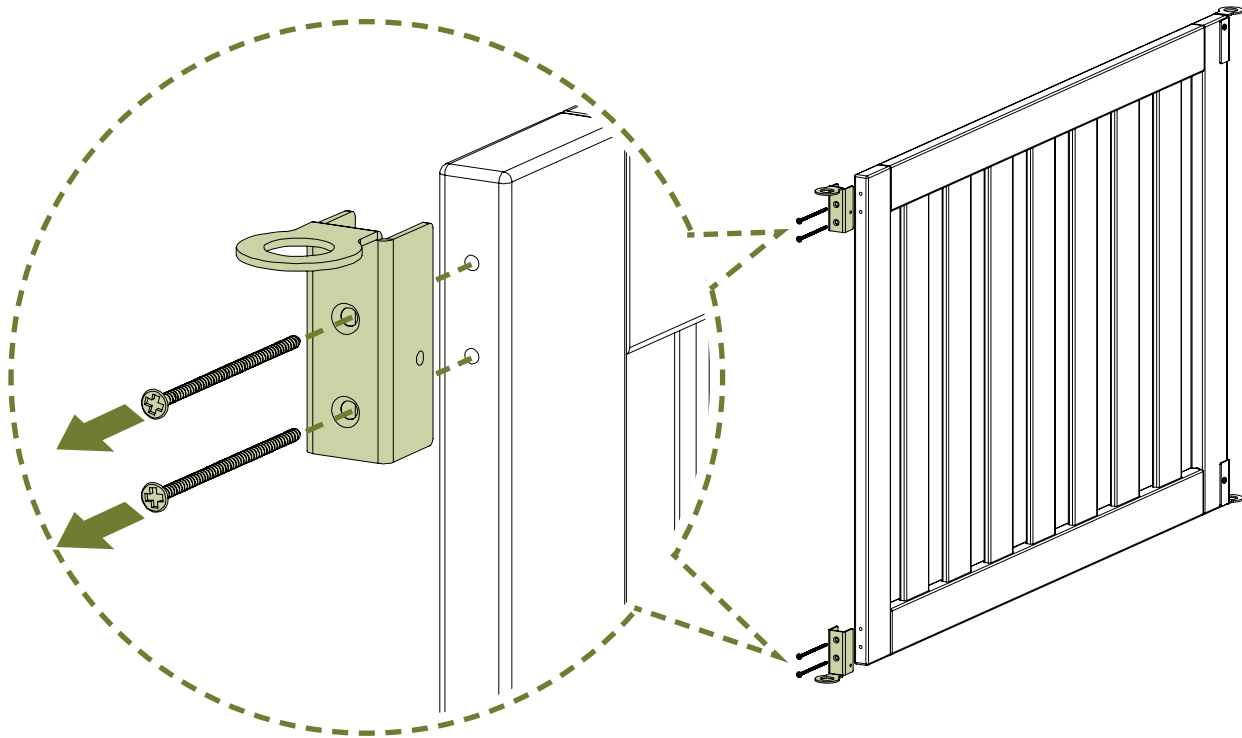

Using the same screws, screw in the top two screws **only**, back into the panel.
Save the other two screws for later

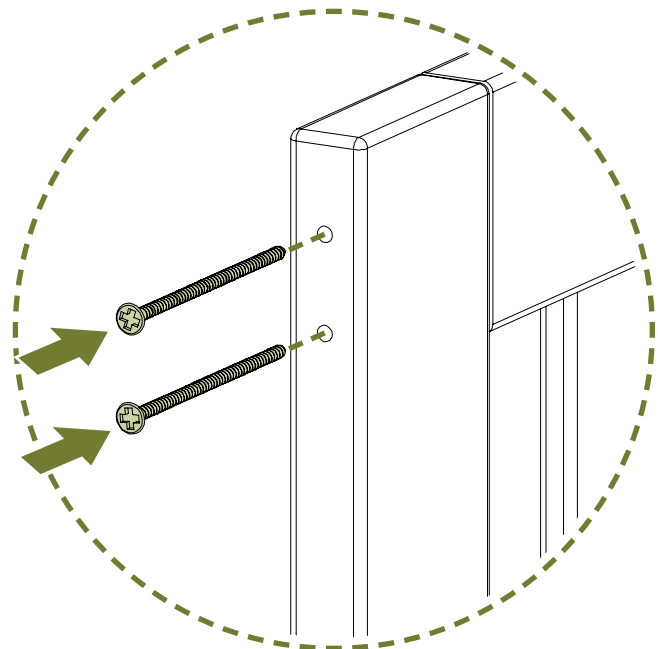

ASSEMBLE UNIT

3

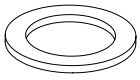

G x2

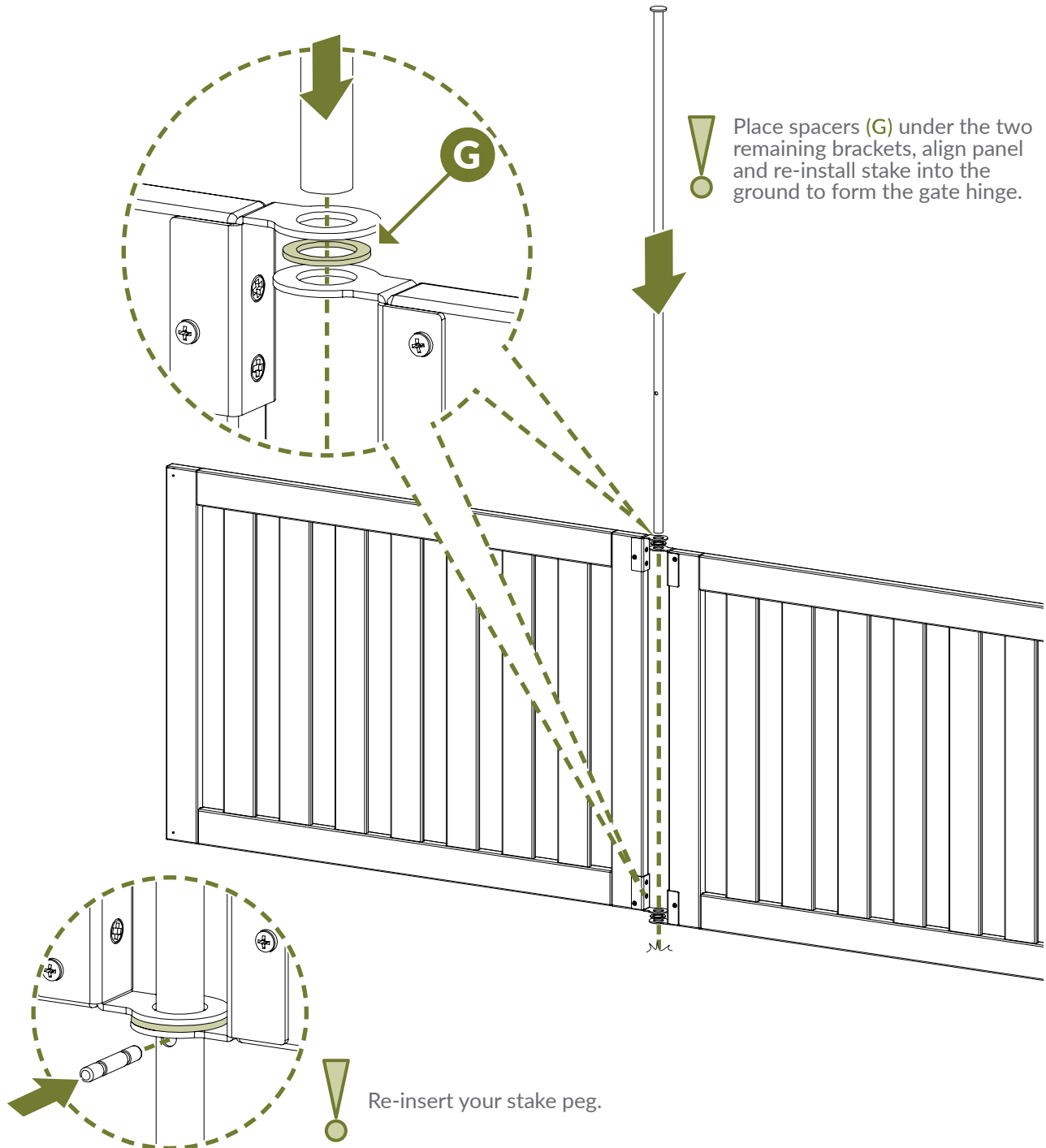

4

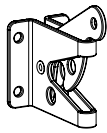

A x1



C x2

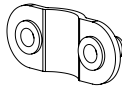

D x2



I x4

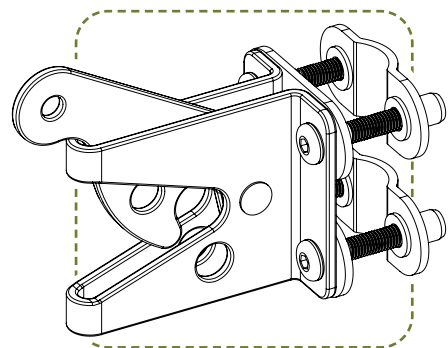
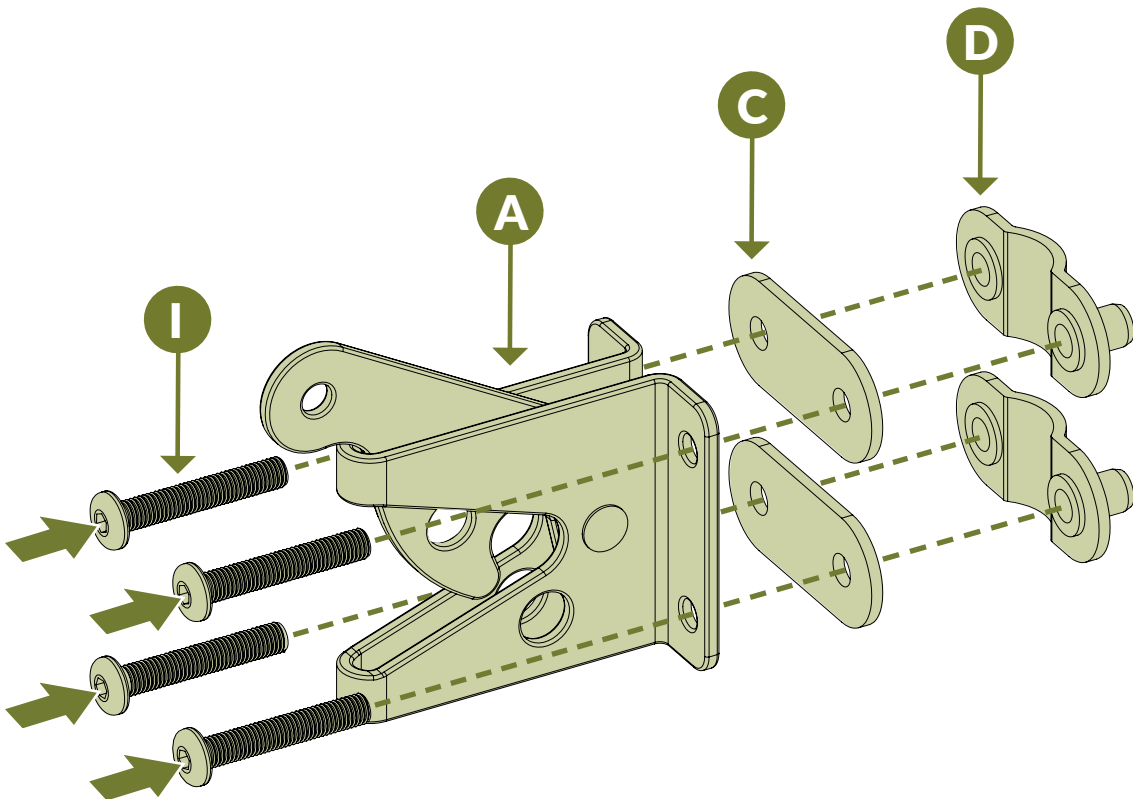

Start bolt (I) by hand,
do not tighten.

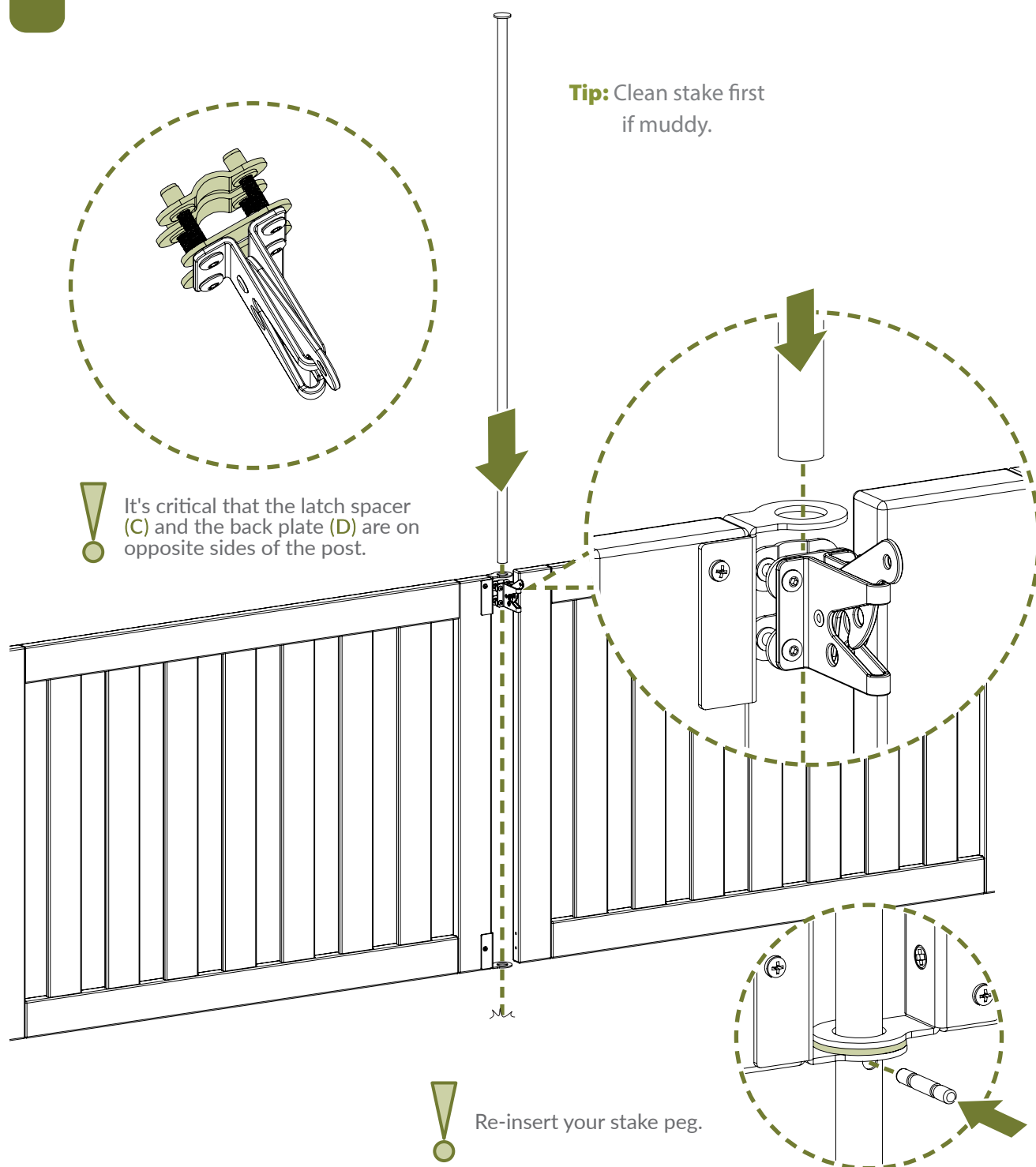

6

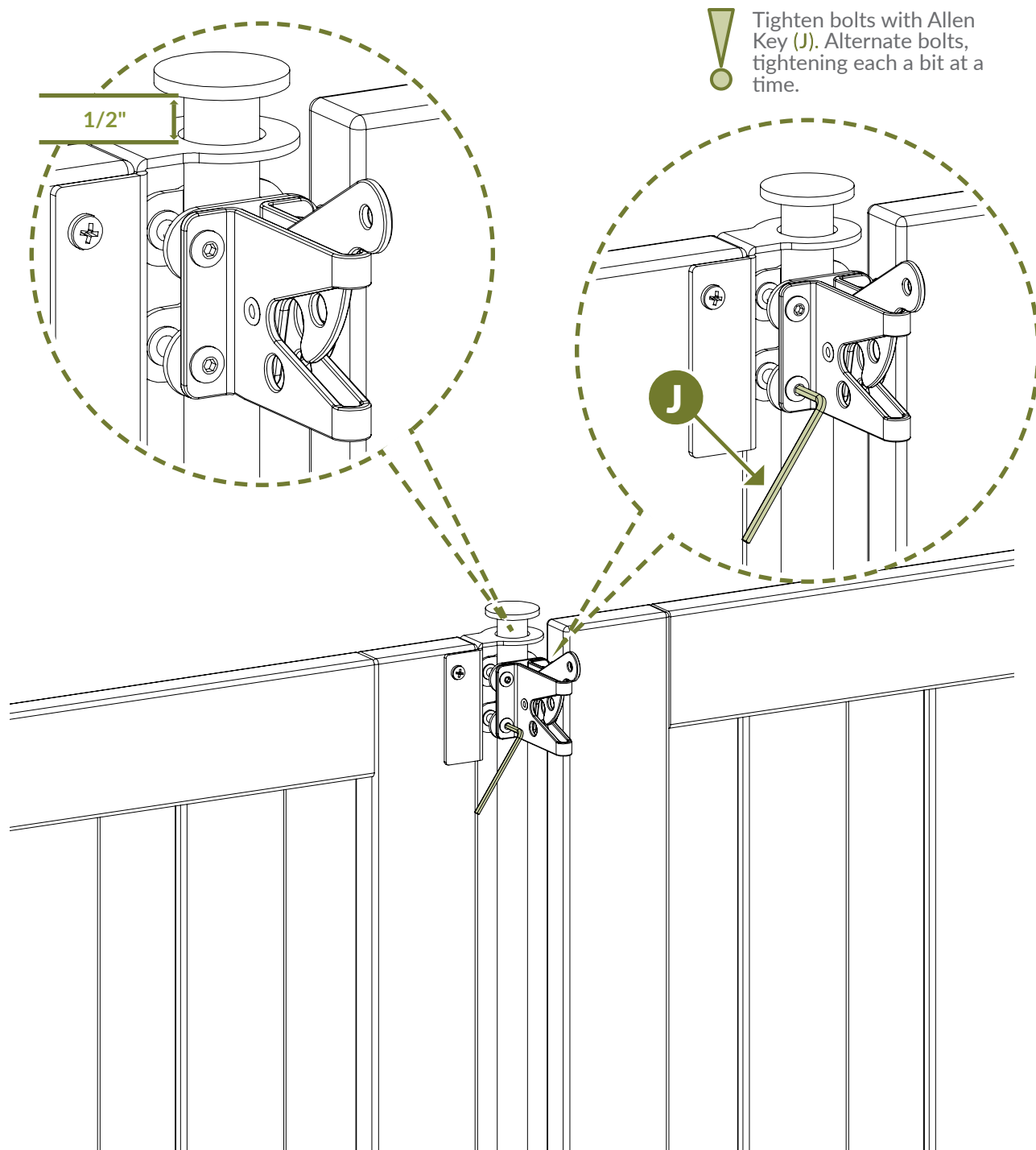

7

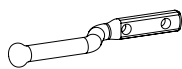
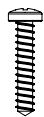
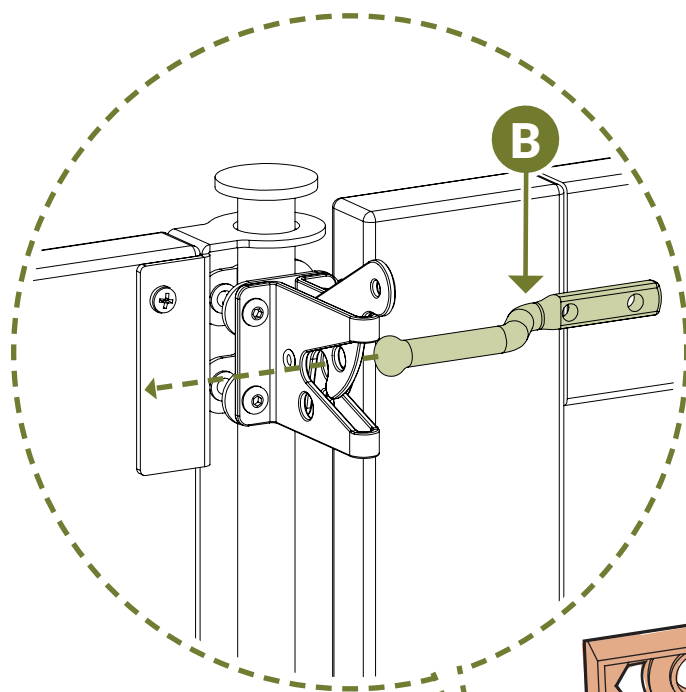
**B** x1**H** x2

Ensure the gate panel is level before screwing in the latch finger (B).

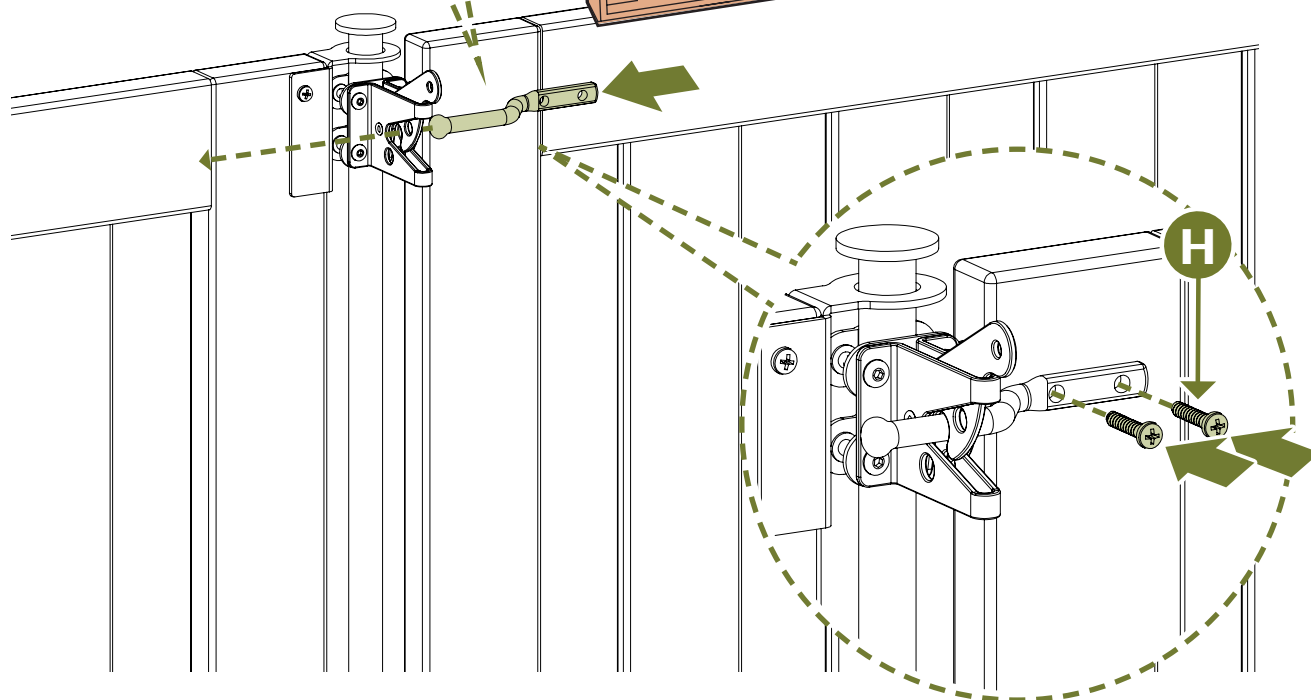
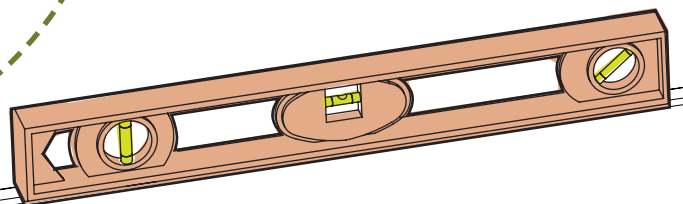

8

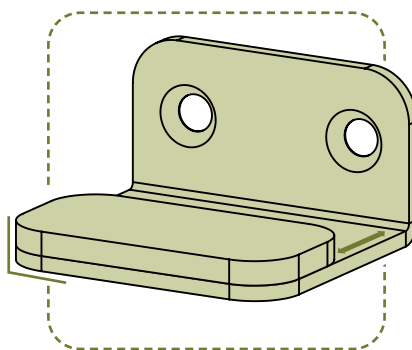
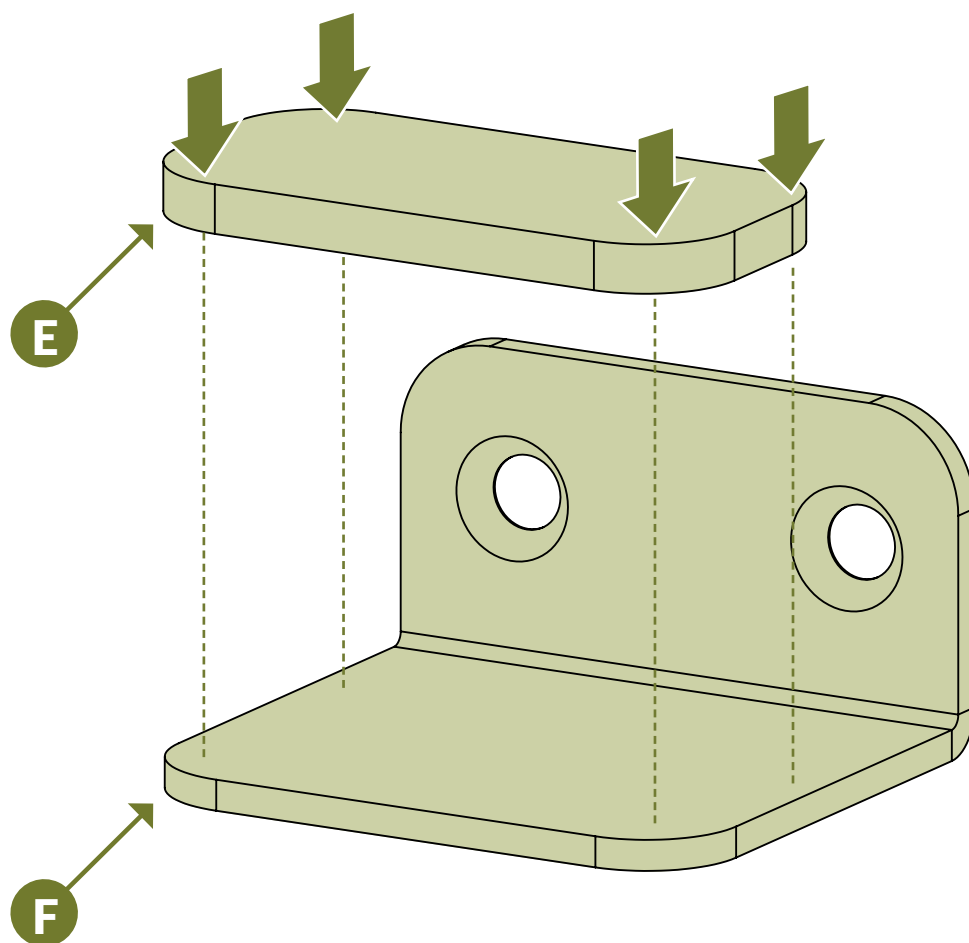

! Align the rubber pad (E) flush to the front edge of the gate stopper (F).

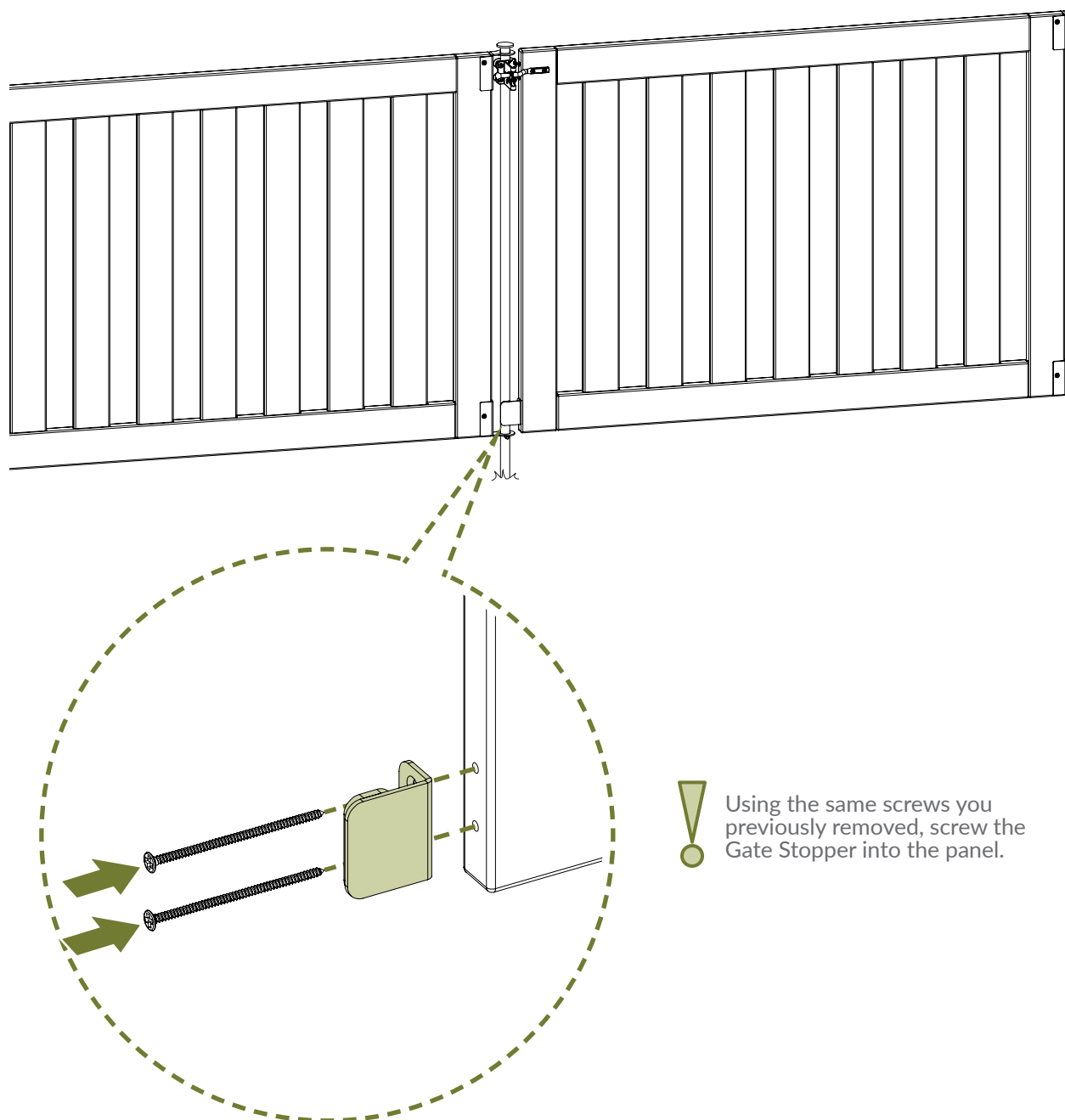

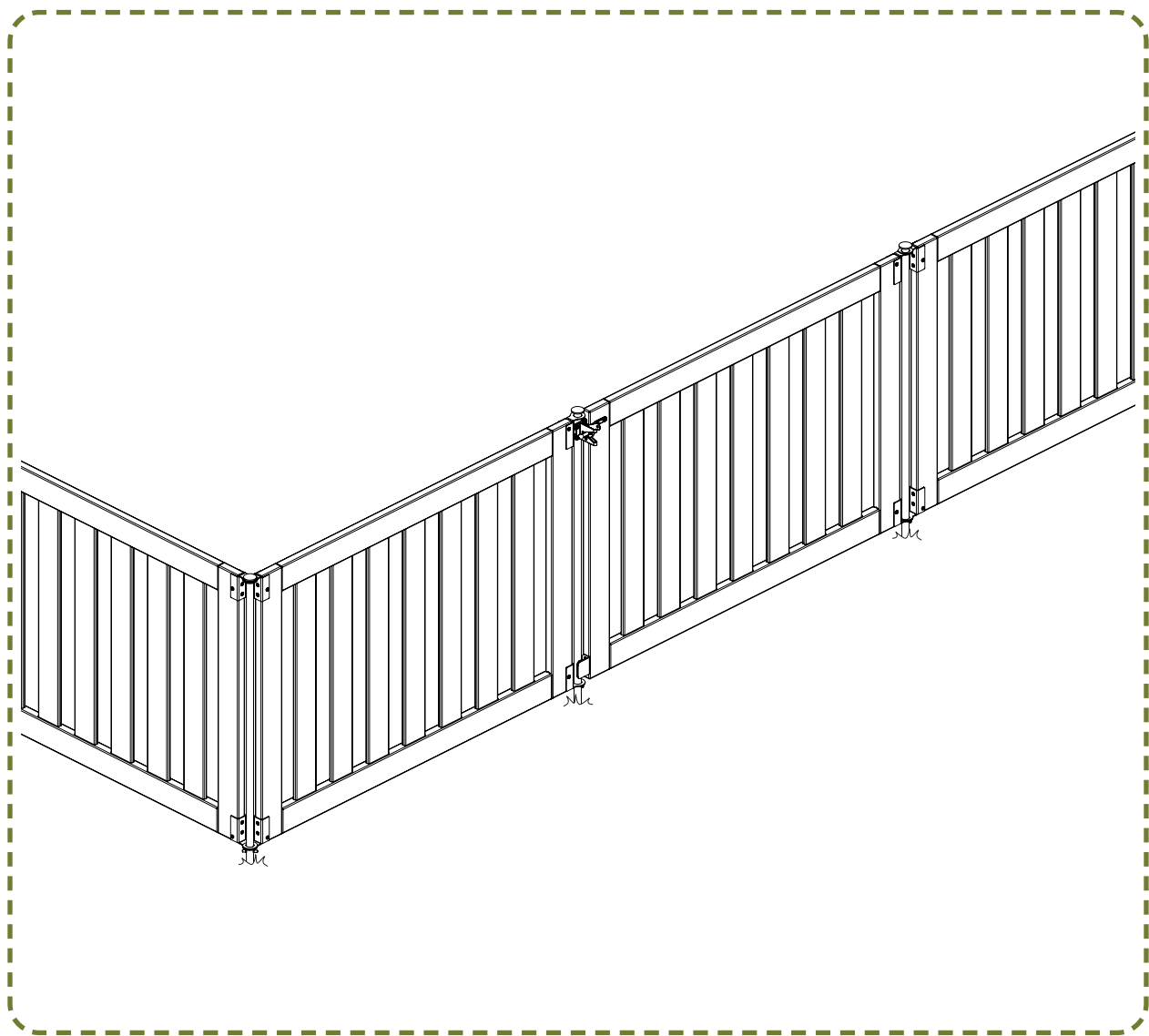



ZIPPITY

Easy Does It!



6935 Reames Rd. Ste. K.
Charlotte, NC 28216



support@zippity-outdoor.com

704-892-5222
877-234-6196



WWW.ZIPPITY-OUTDOOR.COM